

**** PROPRIETARY DATA ****
 THIS DOCUMENT CONTAINS DATA WHICH IS PROPRIETARY OR CONFIDENTIAL TO WV COMM (WV COMMUNICATIONS INCORPORATED). THIS DOCUMENT AND THE DATA CONTAINED HEREIN SHALL NOT BE USED, DUPLICATED, OR ALTERED WITHOUT THE EXPRESSED WRITTEN CONSENT OF WV COMM. ALL RIGHTS ARE RESERVED.

REVISIONS				
ZONE	REV	DESCRIPTION	DATE	APPROVED
	A	RELEASED	5/28/03	JMO

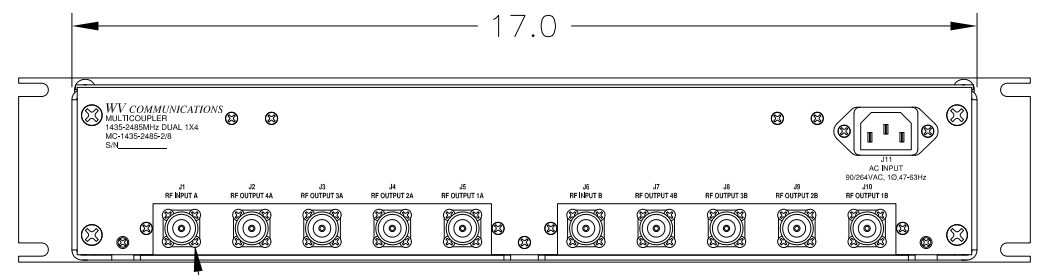
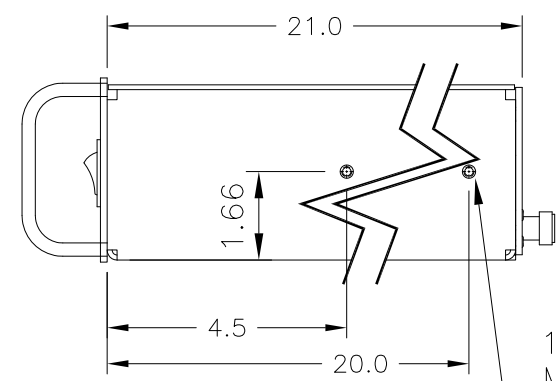
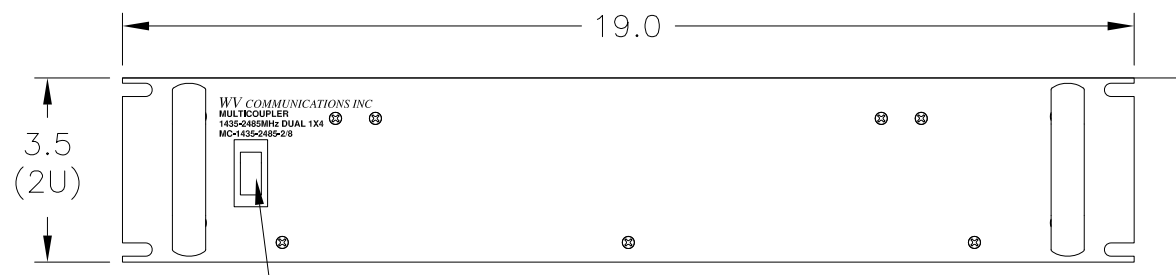

10-32 UNC-2B MOUNTING HOLES
 3.88 SPACED 5 PLACES BOTH SIDES

AC ON/OFF/BREAKER

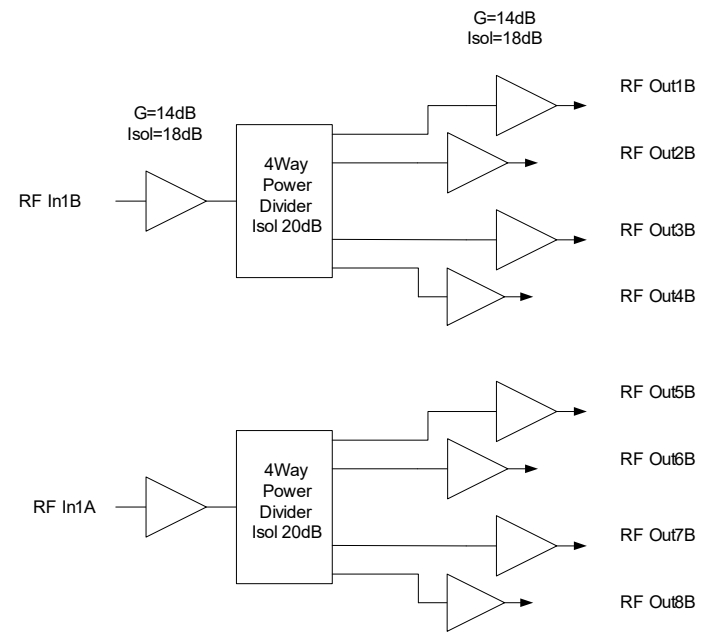

OPERATING FREQUENCY RANGE: 1435-2485MHz
GAIN: Unity ±1dB Nominal
SMALL SIGNAL GAIN FLATNESS: ±1dB Maximum over any 30MHz Band
NOISE FIGURE: 7dB Maximum
ISOLATION OUTPUT PORT TO PORT: 50dB Minimum
ISOLATION INPUT TO OUTPUT PORT: 50dB Minimum
PHASE TRACKING: ±1° Maximum over any 30MHz Band
INPUT & OUTPUT IMPEDANCE: 50Ω Nominal
INPUT & OUTPUT VSWR: 1.5:1 Maximum
INPUT P1dB COMPRESSION POINT: -2dBm Minimum
INPUT POWER WITHOUT DAMAGE: +10dBm Minimum
TEMPERATURE RANGES: Operating 0-50°C
AC INPUT POWER: 90-264VAC Auto Switch / 1.0 Amp Maximum 1 Phase 47-440Hz

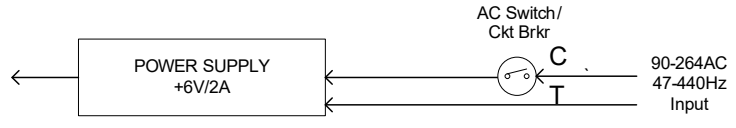

900-50087-002	MC-1435-2485-2/8
NEXT ASSEMBLY	USED ON
APPLICATION	

UNLESS OTHERWISE SPECIFIED: DIMENSIONS ARE IN INCHES. TOLERANCES ARE:
 FRACTIONS DECIMALS ANGLES HOLES
 ± 1/64 .XX±.01 ±0°30' .XX±.005
 .XXX±.005 .XXX+.003 .XXX-.001
 MACHINED FINISH: 32 RMS REMOVE BURRS .005 MAX

MATERIAL

FINISH

DO NOT SCALE DRAWING

APPROVALS	DATE
DRAWN G. GODDARD	5/28/03
CHECKED G.G.	5/28/03
MECH ENGR G.G.	5/28/03
ELEC ENGR J.T.	5/28/03
PRODUCTION A.M.	5/28/03
Q.A. D.B.	5/28/03

WV Communications 1176 Tourmaline Dr. Newbury Park, CA

MULTICOUPLER
 1435-2485MHz Dual 1X4
 WV P/N MC-1435-2485-2/8

SIZE B	CAGE CODE 1GFQ7	DWG. NO. 050-50313	REV A
SCALE NONE		SHEET 1 OF 1	